

OSLO **KONSERTHUS**

VENUE-INFO

Munkedamsveien 14
P.O.Box 1437 Vika
N-0115 Oslo

PHONE: (+47) 23 11 31 00
FAX: (+47) 23 11 31 10
TICKETS: (+47) 23 11 31 11

OSLO CONCERT HALL

GENERAL INFORMATION

SEATS:	Main Hall-1404, Small Hall-266
PRODUCTION COORDINATOR:	Mr. Jan Olsen Skare, jos@okh.no, ext. 23 11 31 52
BOOKING CONTACT:	Ms. Silja S. Borse, ssb@okh.no, ext. 23 11 31 33
MARKETING MANAGER:	Ms. Kristin Sundt, ks@okh.no, ext. 23 11 31 71
STAGE-MANAGERS:	Mr. Hans Olav Lohne, hol@okh.no, ext. 23 11 31 34 Mr. Ragnar Nilsen, m@okh.no, ext. 23 11 31 31
LIGHT-ENGINEER:	Mr. Eskild Øksnes, eskild@okh.no, ext. 23 11 31 90
SOUND-ENGINEER:	Mr. Jan Olsen Skare, jos@okh.no, ext. 23 11 31 52
TECHNICAL MANAGER, SMALL HALL:	Mr. Bernd Starheim, bs@okh.no, ext. 23 11 31 21
ARRANGEMENTS/VERT:	Mr. Steffen Nedregotten, sn@okh.no, ext. 23 11 31 26
STAGE MAIN HALL:	22m wide at the downstage edge, 13m wide at the upstage edge, 13m deep, 7m light cross level.
FLYING:	6 points for lights, 2 points for P.A., 1000 kg. each. For curtains, see attached plot.
MIXER POSITION:	Approx. 30m from stage on both sides
FOLLOWSPOT POSITION:	In lighting control room, approx. 35m from stage
POWER AVAILABLE:	Lights 150A/380v three phase, sound 150A/380v three phase, backline 10x16A/220v single phase, rigging power and land lines on request.
INTERCOM:	Clear-Com with interconnected walkie-talkies. Two line system.
DRESSING ROOMS:	4 rooms with shower/toilet near stage, one star/VIP room, 3 large orchestra wardrobes. 3 large orchestra wardrobes.
PRODUCTION OFFICE:	Near stage on 4th floor, phone/fax-ext. on request. Two phone - lines: (+47) 23113135, (+47)23113144. Lines through switchboard. No direct line.
CATERING:	Oslo Konserthus Restaurantdrift! Ltd. in house. Any own catering must be negotiated with OKHR, mr Jan Johansen or mr. Odd Bjørung, ext. 23113150.
SPECIAL EFFECTS:	Dry ice smoke no problem. Every other kind of smoke or pyro/flash needs a fireman to be present. Please advise at least one week in advance.
LOAD IN:	From parking bay into elevator up to 4th level. Elevator measures 4x3x2,2m. Larger pieces must be carried upstairs by hands.
PARKING:	Room for 3 long vehicles(semi's, busses), 3 places for cars. Please advise arrival and try to come early, (before 7.00 am.)
GET IN:	Weekdays 2.30 P.M., other days by agreement.
GET OUT:	All time used after 11 P.M. will be charged additionally.
GENERAL:	We need to have riders/technical specifications and needed rigging time as early as possible.
MERCHANDISING:	Good facilities in the main entrance area, tables available.
QUESTIONS:	Please don't hesitate to call us.

LIGHT MAIN HALL

CONTROL BOARD:

Avolite Saphire 2000,
Pearl 2000

DIMMERS:

Strand SLD
180- 5Kw
70- 3Kw

LANTERNS:

Five flown lighting trusses over stage area:
21, 5kw fresnels ADB pole operated.
24, 1kw par 64 Thomas with scrollers. 16 colours
6 VL 3000Q Wash. 4 VL 3000Q Spot
4 VL 1000 tungsten with shutters
2 HE Cyberlight

Front of house flown truss:

12, 1kw par 64 Thomas with 16 colour scrollers
2 PML mk2 moving heads

Front Of House fixed bridge:

30 x 2Kw profiles

Floorlights:

10 1kw par 64 Thomas short nose. (Silver)
10 1kw par 64 Thomas short nose. (Black)

Cyclorama lighting:

10 THOMAS 4x1kw asymmetric floods on truss,

MOVING LIGHTS:

4 VariLite VL1000 tungsten w shutters
4 VariLite VL3000 quiet version Spot
6 VariLite VL3000 quiet version wash
2 P.L.M. 1200w HMI E size
2 Cyberlight 1200 MSR SL M - size + glass

COLOUR-SCROLLERS:

12 with Rainbow with eleven colours and plus card.
Gels Rosco Nr. 00, 63, 69, 74, 382, 95, 90, 26, 339, 23, 04.
30 with twentyone colours Painbow Pro 33 8"

FOLLOWSPOTS:

2 x Juliat 2500w HMI1013B ARA

PROJECTOR:

1 BP4 HMI Pani

COLOURS:

Rosco Supergel.

SOUND MAIN HALL

F.O.H. MIXER	Digico D5 – 96 channels with/FX and output processing – 56 stage input
MONITOR MIX:	Digico D5 – 96 channels with/FX and output processing – 56 stage input
STUDIO MIXER:	Digico D5 – 96 channels with/FX and output processing – 56 stage input
AMPS:	P.A. 6 x Crest 4001(2x450w each),delay 2 x C Audio RA3000 2 x QSE EX 4000.
P.A.:	4 x Meyer Sound MSL2 flying/4 UPA1 flying centre cluster. 4 x Meyer Sound MTS 4.
STAGE-STACK:	4x QC 1, 2 x USW1 sub-bass, 2 x 650 sub-bass.
MAIN SYSTEM EQ:	8 ch Klark Technich programable EQ's whith controller.
DELAY:	6 x Turbosound TXD 530/delay TC 1280 for balcony.
MONITOR:	8 x Tannoy Wedges with 15" +tweeter.C Audio amps 8 x EAW sm 400.C Audio amps 6 x EAW sm 200.C Audio amps
EQ'S MONITOR:	10 x TC Electronics 1 x TC Electronics remote controller
MIC'S:	Shure, AKG, , MILAB.Microtec,sennheiser.Audix
RADIO MIC'S:	8 x Sennheiser handheld 800 mghz. OR 8 x Bodypack.
EFFECTS:	TC-Electronic M-5000 dual rev. TC-Electronic 2290 DDL sampler Lexicon 480 L
TAPE MACH.:	3 x DA 88 Tascam 8 track digital with remote control 1Technics 1506 4-tracks 1 Studer A67, 1 Otari MX70 16-trac
CASS. DECKS:	1 NAD 6050 C 1 Kenwood KX-3510
CD-MACHINE:	1 AIWA XC-002
DAT-MACHINES:	1 Kenwood DX 7030 , 1 SONY PCM 2700. All other equipment by agreement.

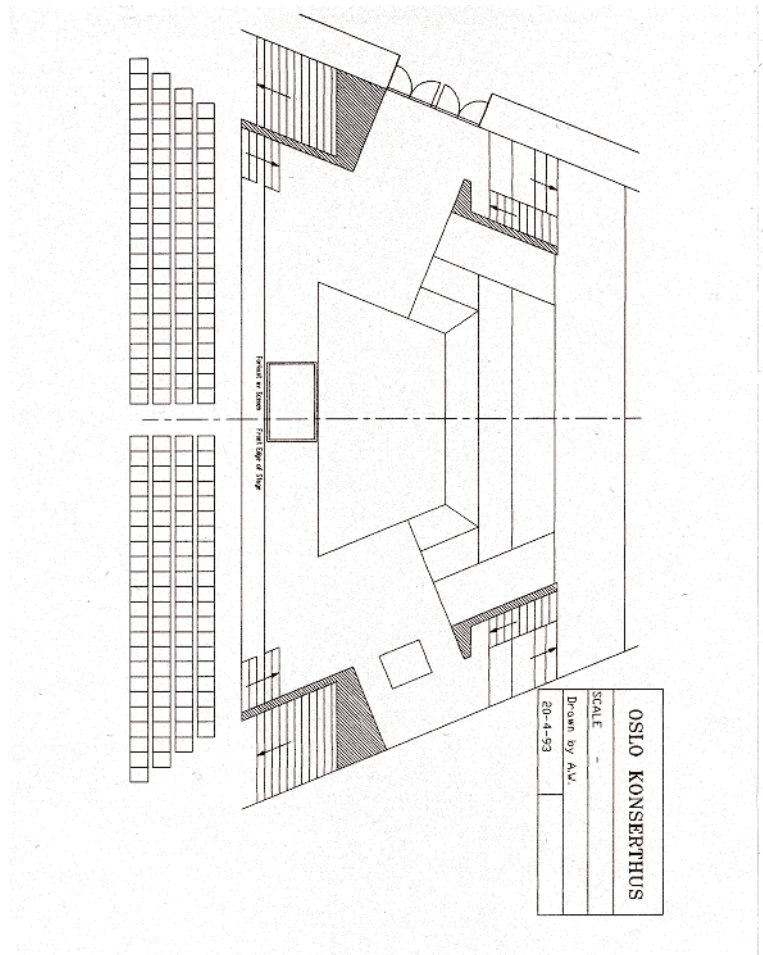
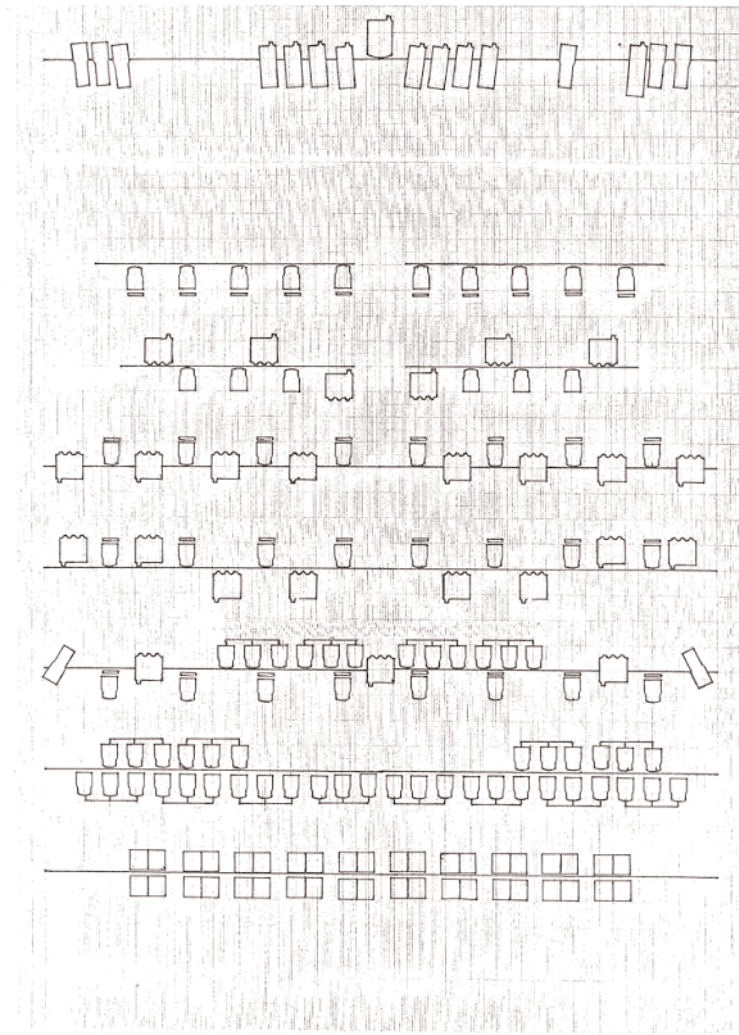



OSLOKONSERTHUS

